

Information of K-Tower Room

Patients can rest comfortably in private rooms with an ocean view & experience a healing environment in our "K-Tower" .

K-TOWER Room charge list					
Floor division	Women's Floor	General Floor	Executive Floor		
	4-5th Floor	6-11th Floor	A	B	C
Room Charge (per one day)	¥12,600	¥12,600	¥52,500	¥31,500	¥12,600
Number of rooms	62	178	1	6	17
Room Size	21㎡	21㎡	60㎡	45㎡	21㎡

(As of October, 2009)

General Floor

General Room 21m²

12,600yen

Almost all of the rooms have a spectacular Pacific Ocean view, and the room size is 21㎡. Each room is complete with a bed side monitor which contains internet, TV, and access to your medical record (if desired). The headboard with designer fabric inlay hides the medical gas, emergency electricity outlets, and vacuum ports. There is a sink in every room as well as a private toilet and shower. The bed side monitor, as previously described, is installed in every room as well as a sofa bed for an overnight guest or visitor.

Facilities and Furnishings of the Room

Bed side monitor (Internet, TV), telephone, air conditioning, sink, shower, toilet, closet, refrigerator, sofa bed, safety box, tea set, hot water pot, standard lamp, stationary (Information book).

Also Supplied

Towel (Face towel & bath towel), mat, shampoo & hair conditioner, body soap, drinking cup
 ※ Hair dryer in Women's floor. (In other floor, we will rent, if you want.)

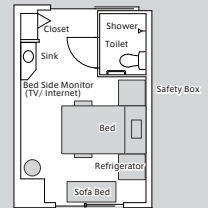

Executive Floor - A type -

Executive Room 60m²

52,500yen

The Executive Floor within the K-Tower is designed with the highest level of privacy, security and amenity. For patients requiring an exceptional level of privacy and security, we have suite rooms that can accommodate family members and staff who can accommodate their needs as well as our standard high amenity rooms. Kameda has many physicians on staff who are fluent in English, and several who have completed their postgraduate education in the United States or elsewhere abroad and are dual licensed. Foreign patients are welcome and we will do our best to accommodate language, religious or cultural needs. This room is similar to a private suite in a major hotel. It has a panoramic spectacular Pacific Ocean view.

Facilities and Furnishings of the Room

The general room's amenities+
 Mini-kitchen, bathroom with Jacuzzi, fridge-freezer, dining table (with 6 chairs), high-vision TV (2), sofa bed, desk, dishes, glasses. There is a concierge service to accommodate any need.

Also Supplied

The general room's amenities +
 Hair dryer, Shampoo/ Hair conditioner/ Shower gel/ Body lotion, Kleenex

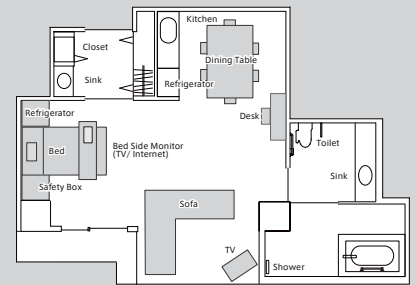

Executive Floor - B type -

Executive Room 45m²

31,500yen

The type B room is 45㎡, and is also a spectacular ocean view room. The room-size is slightly larger than a general room. Amenities like hotel are prepared, and we support your comfortable hospitalization life.

Facilities and Furnishings of the Room

The general room's amenities +
 Bathroom, High Vision Wide-TV

Also Supplied

The general room's amenities +
 Hair dryer, Shampoo/ Hair conditioner/ Shower gel/ Body lotion, Kleenex

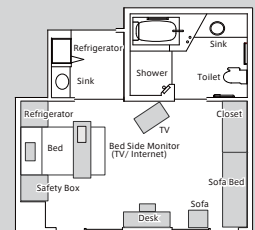

- You can watch TV, use the Internet and see your Electronic Medical Record using "PLANET" with the bed side monitor placed in your room. If you want to use "PLANET", you are required to register for it in advance.
- We have devoted 2 floors (4th & 5th floor) of the K-Tower exclusively for Women.
- If you don't have any food restriction, you can choose from other menus with an extra charge.
- If your visitors would like to have lunch or dinner with you in your room, please order "room service".
- Specially approved visitors such as family members can be permitted 24 hours a day by patients hospitalized in the K-Tower.
- There is a sofa bed for a patient's family to be able to stay with him/her overnight.
- Concierge service supports the patient's comfortable hospital stay.
- If you are planning to use any personal electronic devices, please note that Japan's electricity is 50Hz and 105V, but most modern electrical devices can accommodate this difference.
- If you have a three prong connector, you may need an adapter that converts it to the more common two prong connector for use in most electrical outlets in Japan. An electrical transformer is usually not needed.